



DOLTONE HOUSE

venue collection + catering

JONES BAY WHARF

BUSINESS EVENTS

SELECT YOUR SPACE

HERITAGE WHARF

SOHO

THE LOFT

TRIBECA

TRIBUTE MUSEUM

HARBOUR

SUITE 55



DOLTONE HOUSE

venue collection + catering

HERITAGE WHARF

SYDNEY HARBOUR BACKDROP

Doltone House Jones Bay Wharf
is a unique heritage venue situated on the
restored historic finger wharf at Jones Bay Wharf, Pyrmont.

It is a spectacular waterfront venue on the foreshore of Sydney
Harbour, with views of the Harbour Bridge, city skyline and the
Darling Harbour precinct.

WINNER

MEETINGS AND EVENTS INDUSTRY HALL OF FAME
SPECIALTY MEETING VENUE

Jones Bay Wharf - HERITAGE WHARF

- Waterfront location with versatile spaces for up to 1000 guests
- Elevated full length private outdoor decking area with Harbour Bridge / City views
- 5 metre pillarless high ceiling with multiple rigging points
- State of the art Audio Visual (AV), lighting and staging infrastructure
- Two commercial kitchens with dedicated Kitchen crews
- Blackout facilities
- Lift and disabled access

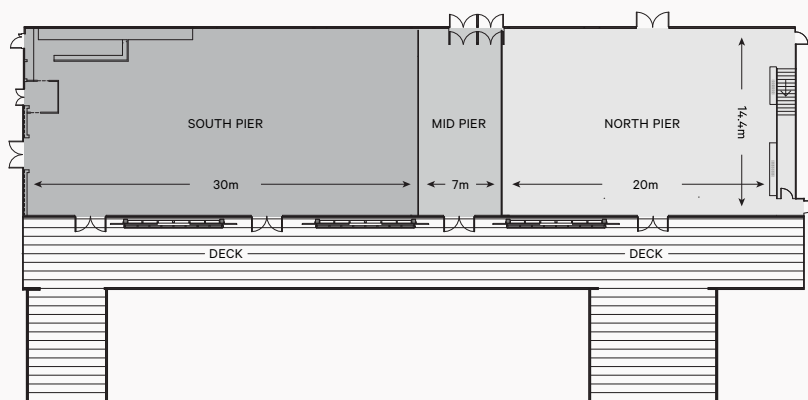

Waterfront venue with Harbour Bridge and city skyline views



FOOD & CATERING - AWARD WINNING -

Serving Sydney's best quality produce, from the freshest of seafoods, and the premium cut of meats, we source only the highest standard for you.

CAPACITIES & FACILITIES

	Heritage Wharf	South Pier	North Pier	The Loft
COCKTAIL	1000	500	400	250
BANQUET	680	340	250	160
THEATRE	900	420	350	120
CLASSROOM	460	240	150	60
AUDIO VISUAL	✓	✓	✓	✓
VIDEO CONFERENCING	✓	✓	✓	-
PARKING	✓	✓	✓	✓
DISABLED ACCESS	✓	✓	✓	Ground floor
HIGH SPEED WIFI INTERNET	✓	✓	✓	✓

Not to scale, capacities subject to event set up requirements and DA conditions.

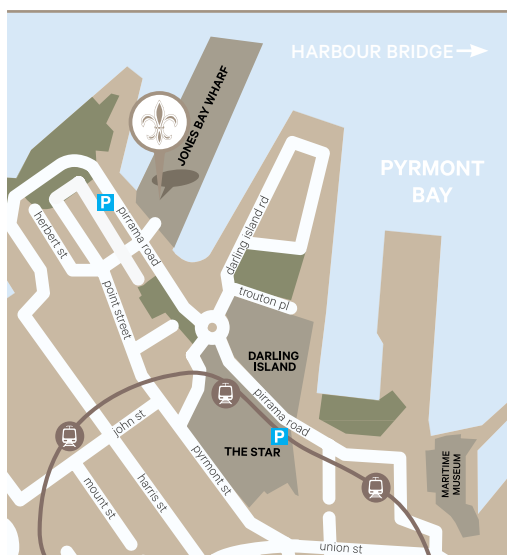

LOCATION

The setting offers an event experience on the best harbour in the world, an ideal venue location and a very unique address for your next event.

Only minutes from our Darling Island venue and the Darling Harbour precinct, Doltone House Jones Bay Wharf is within easy walking distance of the CBD and all the attractions that Sydney city has to offer.

The venue may be accessed by boat, water taxi, ferry, light rail, bus or private transport.

Jones Bay Wharf
26-32 Pirrama Road,
Pyrmont. 2009

PARKING

Parking is available directly across the road from the venue in the Jones Bay Wharf Car Park or at The Star. You may enter the venue from the street level stairs or dedicated lift on Pirrama Road.



DOLTONE HOUSE

venue collection + catering

SoHo

Complementing Jones Bay Wharf's heritage charm, newest addition to the venue portfolio. Multi award winning designer, Greg Natale's New York inspired studio design, ideal for meetings, dining and mingling with elevated harbour views.

JONES BAY WHARF – SOHO

- C-level management suite
- Breakout meeting space
- Private dining, exclusive designer space
- Lectern/Microphone, surround speakers for background music
- 65" LCD screen
- Projector and screens available
- Outdoor private elevated decking
- Floor to ceiling windows
- Abundance of natural light
- Two level designer contemporary fit out
- Blackout facilities available



Not to scale, capacities subject to event set up requirements and DA conditions.

FOOD & CATERING

- AWARD WINNING -

Serving Sydney's best quality produce, from the freshest of seafoods, and the premium cut of meats, we source only the highest standard for you.

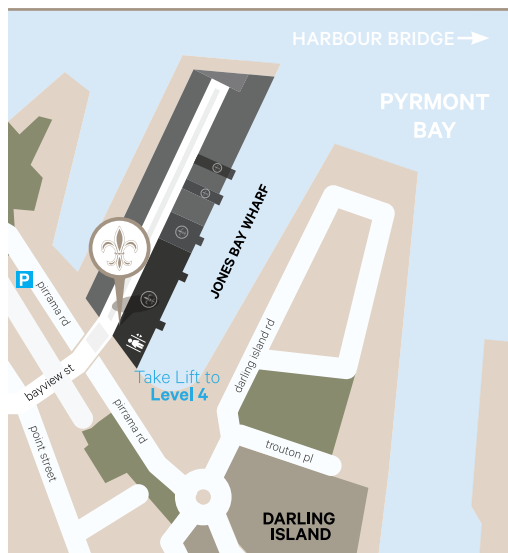

LOCATION

The setting offers an event experience on the best harbour in the world, an ideal venue location and a very unique address for your next event.

Only minutes from our Darling Island Wharf venue and the Darling Harbour precinct, Doltone House Jones Bay Wharf is within easy walking distance of the CBD and all the attractions that Sydney city has to offer.

The venue may be accessed by boat, water taxi, ferry, light rail, bus or private transport.

Jones Bay Wharf
Level 4
26-32 Pirrama Road,
Pyrmont 2009

PARKING

Parking is available directly across the road from the venue in the Jones Bay Wharf Car Park or at The Star. You may enter the venue from the street level stairs or dedicated lift on Pirrama Road.



DOLTONE HOUSE

venue collection + catering

THE LOFT

SYDNEY HARBOUR BACKDROP

Doltone House Jones Bay Wharf
is a unique heritage venue situated on the
restored historic finger wharf at Jones Bay Wharf, Pyrmont.

It is a spectacular waterfront venue on the foreshore of Sydney
Harbour, with views of the Harbour Bridge, city skyline and the
Darling Harbour precinct.

WINNER

MEETINGS AND EVENTS INDUSTRY HALL OF FAME
SPECIALTY MEETING VENUE

Jones Bay Wharf - LOFT

- Waterfront location
- Private deck area with Harbour Bridge / City views
- Fully air-conditioned
- Features polished wooden floors, white gold mosaic tiles and a marble bar
- Private entrance for VIP arrival
- Natural light
- Telephone lines
- Internet access
- Lift and disabled access

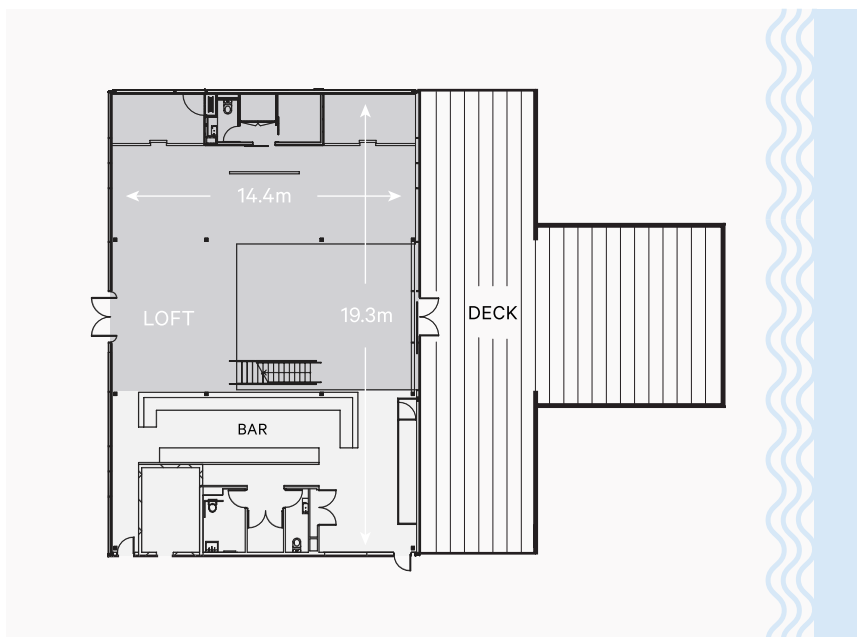

CAPACITIES	BANQUET	COCKTAIL	THEATRE	BOARDROOM	CABARET	CLASSROOM
	160	250	120	50	80	60

Not to scale, capacities subject to event set up requirements

FOOD & CATERING

- AWARD WINNING -

Serving Sydney's best quality produce, from the freshest of seafoods, and the premium cut of meats, we source only the highest standard for you.



LOCATION

The setting offers an event experience on the best harbour in the world, an ideal venue location and a very unique address for your next event.

Only minutes from our Darling Island venue and the Darling Harbour precinct, Doltone House Jones Bay Wharf is within easy walking distance of the CBD and all the attractions that Sydney city has to offer.

The venue may be accessed by boat, water taxi, ferry, light rail, bus or private transport.

Jones Bay Wharf
26-32 Pirrama Road,
Pyrmont. 2009

PARKING

Parking is available directly across the road from the venue in the Jones Bay Wharf Car Park or at The Star. You may enter the venue from the street level stairs or dedicated lift on Pirrama Road.



DOLTONE HOUSE

venue collection + catering

TRIBECA

URBAN STYLE SYDNEY HARBOUR SPACE

This urban yet tailored luxe multi-use dining space boasts a contemporary and sharp feel with bespoke tartan carpet contrasted against a geometric tile. A combination of exposed brick, wood cube and crisp white panels adorn the walls. Tribeca features an opulent jewel-toned private bar and understated antique brass sphere pendants across the exposed ceiling. The waterfront location offers an outdoor entertaining area overlooking the Sydney Harbour Bridge.

JONES BAY WHARF – TRIBECA

- Waterfront location with Sydney Harbour Bridge views
- Indoor / outdoor space
- C-level management suite
- Exclusive designer space
- Private bar
- Outdoor entertaining area overlooking Sydney Harbour and city skyline
- Commercial kitchen
- Lectern/Microphone, surround speakers for background music
- Audio Visual (AV) available*
- Suitable as breakout meeting space

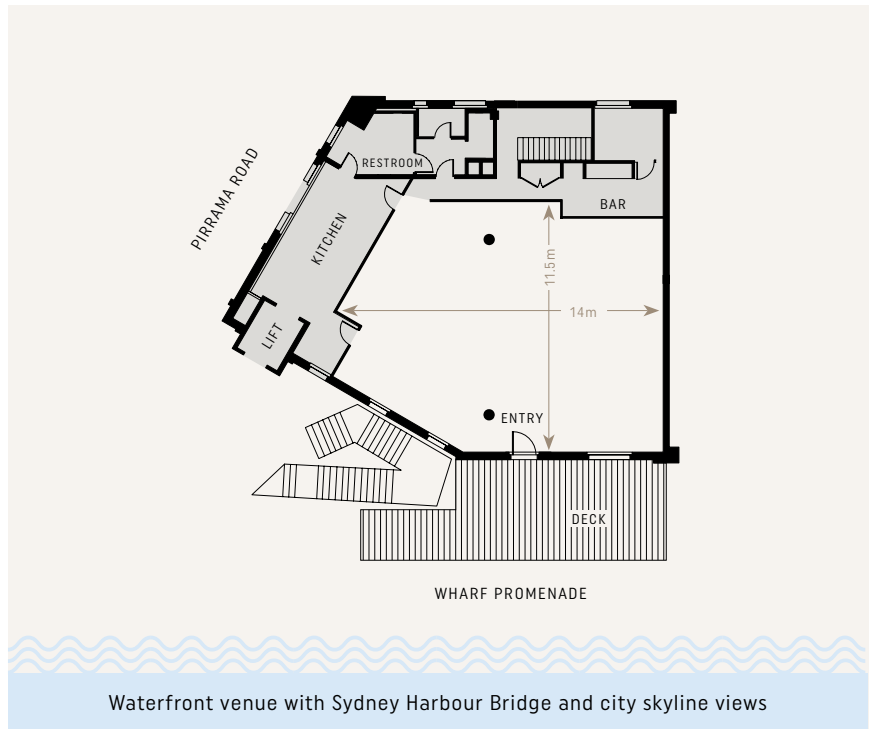

*Additional charges apply.

FOOD & CATERING

- AWARD WINNING -

Serving Sydney's best quality produce, from the freshest of seafoods, and the premium cut of meats, we source only the highest standard for you.



LOCATION

The setting offers an event experience on the best harbour in the world, an ideal venue location and a very unique address for your next event.

Only minutes from our Darling Island venue and the Darling Harbour precinct, Doltone House Jones Bay Wharf is within easy walking distance of the CBD and all the attractions that Sydney city has to offer.

The venue may be accessed by light rail, bus or private transport.

Jones Bay Wharf
Ground Floor
26-32 Pirrama Road,
Pyrmont 2009

PARKING

Parking is available directly across the road from the venue in the Jones Bay Wharf Car Park or at The Star. You may enter the venue from the street level on Pirrama Road.



DOLTONE HOUSE

venue collection + catering



TRIBUTE MUSEUM

ECLECTIC MUSEUM ON SYDNEY HARBOUR

Tribute Museum showcases a collection of historical photographic memorabilia and pays homage to Jones Bay Finger Wharf built in 1919. The space features the original vertical wool bale chute, timber staircase and large cargo sliding door and boasts floor to ceiling windows which create a natural abundance of light.

The hanging vintage wine decanter light and black mesh ceiling installation creates a stylish urban vibe. While the versatile bar with black and gold detailing enhances the industrial feel and the outdoor timber entertaining deck overlooks the spectacular Sydney Harbour bridge.

JONES BAY WHARF – TRIBUTE MUSEUM

- Waterfront location with Sydney Harbour Bridge views
- Indoor / outdoor space over two levels
- C-level management suite
- Exclusive designer space
- Private bar
- Outdoor entertaining area overlooking Sydney Harbour and city skyline
- Floor to ceiling windows
- Abundance of natural light
- Lectern/Microphone, surround speakers for background music
- Audio Visual (AV) available*
- Suitable as breakout meeting space

*Additional charges apply.

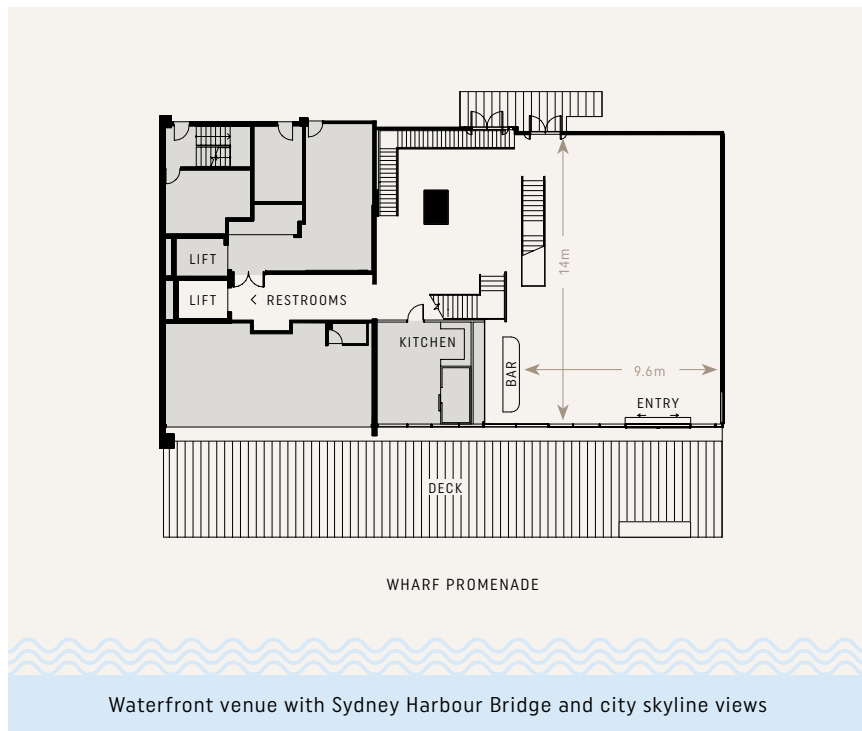

FOOD & CATERING

- AWARD WINNING -

Serving Sydney's best quality produce, from the freshest of seafoods, and the premium cut of meats, we source only the highest standard for you.

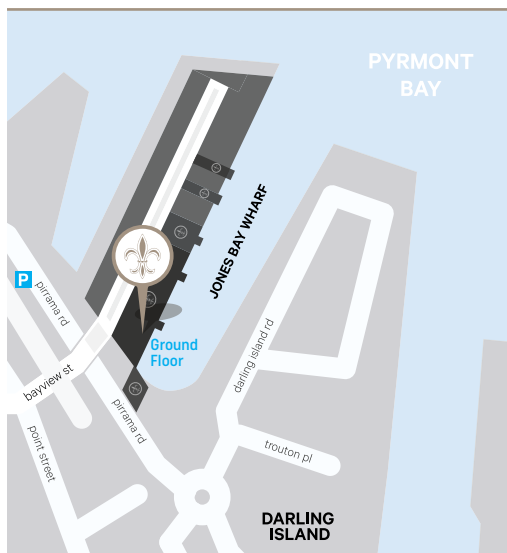

LOCATION

The setting offers an event experience on the best harbour in the world, an ideal venue location and a very unique address for your next event.

Only minutes from our Darling Island venue and the Darling Harbour precinct, Doltone House Jones Bay Wharf is within easy walking distance of the CBD and all the attractions that Sydney city has to offer.

The venue may be accessed by light rail, bus or private transport.

Jones Bay Wharf
Ground Floor
26-32 Pirrama Road,
Pyrmont 2009

PARKING

Parking is available directly across the road from the venue in the Jones Bay Wharf Car Park or at The Star. You may enter the venue from the street level on Pirrama Road.



DOLTONE HOUSE

venue collection + catering



HARBOUR

NEW YORK LOFT INSPIRED SPACE

Inspired by New York loft designs, Harbour is situated on level 2 of Jones Bay Wharf. The exclusive space features high ceilings with exposed steel beams emulating an industrial yet sleek design with statement black window frames. A grand rustic rope lighting pendant hangs over the private bar while floor to ceiling windows allow an abundance of natural light with views of the iconic Sydney Harbour Bridge.

JONES BAY WHARF – HARBOUR

- Waterfront location with Sydney Harbour Bridge views
- C-level management suite
- Exclusive designer space
- Private bar
- Floor to ceiling windows
- Abundance of natural light
- Lectern/Microphone, surround speakers for background music
- Audio Visual (AV) available*
- Suitable as breakout meeting space

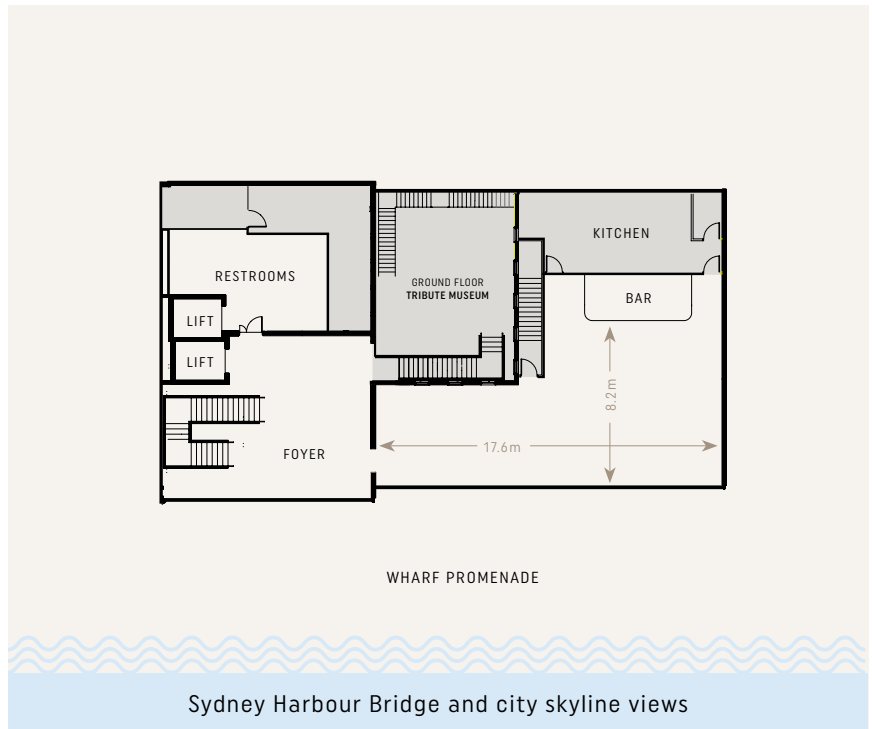

*Additional charges apply.

FOOD & CATERING

- AWARD WINNING -

Serving Sydney's best quality produce, from the freshest of seafoods, and the premium cut of meats, we source only the highest standard for you.

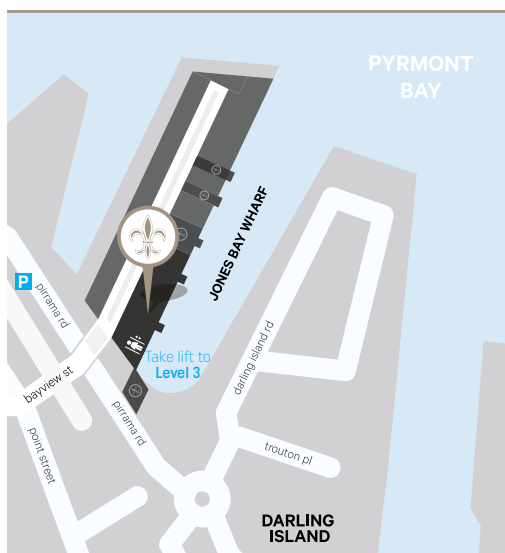

LOCATION

The setting offers an event experience on the best harbour in the world, an ideal venue location and a very unique address for your next event.

Only minutes from our Darling Island venue and the Darling Harbour precinct, Doltone House Jones Bay Wharf is within easy walking distance of the CBD and all the attractions that Sydney city has to offer.

The venue may be accessed by light rail, bus or private transport.

Jones Bay Wharf
Level 2
26-32 Pirrama Road,
Pyrmont 2009

PARKING

Parking is available directly across the road from the venue in the Jones Bay Wharf Car Park or at The Star. You may enter the venue from the street level stairs or dedicated lift on Pirrama Road.



DOLTONE HOUSE

venue collection + catering

SUITE 55

SYDNEY HARBOUR BACKDROP

Doltone House Jones Bay Wharf
is a unique heritage venue situated on the
restored historic finger wharf at Jones Bay Wharf, Pyrmont.

It is a spectacular waterfront venue on the foreshore of Sydney
Harbour, with views of the Harbour Bridge, city skyline and the
Darling Harbour precinct.

WINNER

MEETINGS AND EVENTS INDUSTRY HALL OF FAME
SPECIALTY MEETING VENUE

Jones Bay Wharf - SUITE 55

- Waterfront location
- Private deck area
- Lift and disable access
- Fully air-conditioned
- Custom fit-out by Award Winning Designer
- Natural light
- Views of city skyline
- Plasma screen
- Internet access
- Telephone lines

CAPACITY

12 + 8

Not to scale, capacities subject to event set up requirements

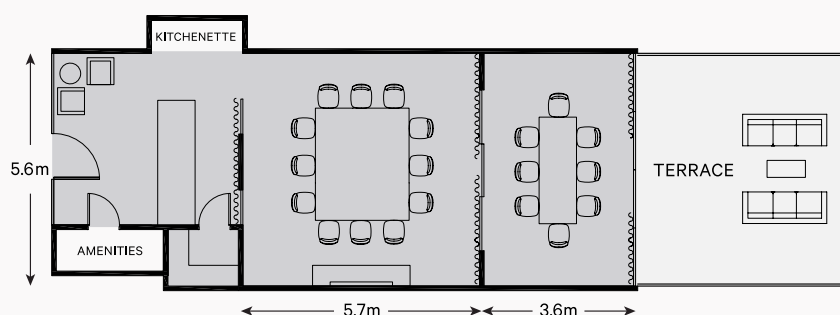

Waterfront venue
with Harbour Bridge and
city skyline views

FOOD & CATERING

- AWARD WINNING -

Serving Sydney's best quality produce, from the freshest of seafoods, and the premium cut of meats, we source only the highest standard for you.



LOCATION

The setting offers an event experience on the best harbour in the world, an ideal venue location and a very unique address for your next event.

Only minutes from our Darling Island venue and the Darling Harbour precinct, Doltone House Jones Bay Wharf is within easy walking distance of the CBD and all the attractions that Sydney city has to offer.

The venue may be accessed by boat, water taxi, ferry, light rail, bus or private transport.

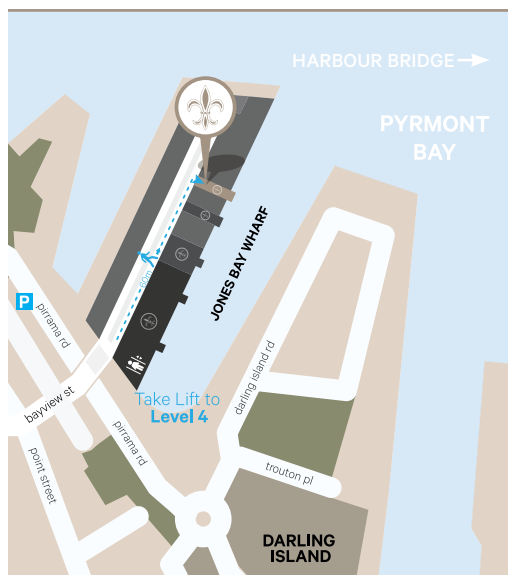

Jones Bay Wharf
26-32 Pirrama Road,
Pyrmont. 2009

PARKING

Parking is available directly across the road from the venue in the Jones Bay Wharf Car Park or at The Star. You may enter the venue from the street level stairs or dedicated lift on Pirrama Road.



DOLTONE HOUSE

venue collection + catering

JONES BAY WHARF

26-32 PIRRAMA ROAD,
PYRMONT 2009

P 02 8571 0622

E INFO@DOLTONEHOUSE.COM.AU

DOLTONEHOUSE.COM.AU